

SUGGESTIONS / FACTORS TO CONSIDER

BIANCO CARRARA	PIETRA D'AVOLA	CREMA D'ORCIA	IMPERIALE
<p>The small holes, commonly referred to as "tarolo", are a natural characteristic of Bianco Carrara. In the Stone Parquet finish, this characteristic should be highlighted, leaving them open. Only in the case of tiling the inside of a shower or other areas in constant contact with water should the holes be filled with Mapei Keracolor FF White 100.</p>	<p>Upon arrival, Pietra d'Avola may have a dark grey colour that is quite different from the treated samples found at points of sale. This is absolutely normal; the dark and intense colour will appear as soon as the FILA STONEPLUS treatment is applied.</p> <p>Pietra d'Avola is a compact material with a very low absorbency coefficient. As a result, most of the water-oil-repellent products on the market are too dense and tend to create a film on the surface of the tile that is difficult to remove. Therefore, to provide maximum stain resistance we recommend using FILA STONEPLUS.</p>	<p>Given this stone's level of absorption, we recommend quickly removing the excess grout deposited on the surface as soon as you notice it starting to dry (time varies depending on the season and temperature).</p> <p>The small holes are a natural feature of Crema d'Orcia.</p>	<p>The holes you see are a natural characteristic of Imperiale. During the grouting phase, the holes should be also be filled, so as to create a uniform appearance.</p>

In the stone sector, it is common to report nominal dimensions, applying the EC rules for which precise dimensional tolerances are set. This does not compromise the quality of the product nor will it create problems during installation.



The process which creates our Stone Parquet tiles is designed to preserve the natural aesthetic qualities of the stone. As a result of this, the tiles may not be perfectly identical, however this non-uniformity is intrinsic both to the texture and the natural stone itself.

SUGGESTIONS / BEFORE BEGINNING



Caution: a square metre of tiles from the Stone Parquet collection weighs between 32 and 33 kg. Take care to keep your back straight when lifting them.



Caution: wear the required protective clothing when accessing work areas. This will reduce the risk of injury.



Unpack the tiles and check to see that they are in good condition. If there are any damages, do not proceed with installation. Notify your retailer within the specified timeline. Returns are not accepted once the tiles have been installed.



The material could arrive on site still damp (this is due to the use of water in the processing stages). As a result, the colour may appear darker. You can easily check to see if the material is damp by exposing it directly to a heat source for a few seconds. It should start to lighten visibly and return to its original tone.

SUGGESTIONS / SPECIAL NOTES



Caution: if you have a radiant underfloor heating system, we recommend keeping the system turned off for the duration of the various laying phases.

LAYING PATTERN

If you are using 7 x 60 cm tiles, we recommend the following laying patterns:



Orthogonal laying pattern



Running laying pattern (at random or regular intervals, depending upon personal choice)



Herring-bone

If you are using mixed length tiles (41 - 81 - 122 x 19.8 - 15 cm) they should be laid in a running pattern:



Regular intervals depending on personal preference

DRY LAYING

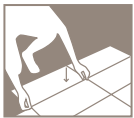

Lay the tiles according to the pattern desired. Being a natural material, the tiles will not have a uniform colour, and therefore we advise you to give some thought during this stage to how you mix the variations in tonality to give you the best overall effect.

PRETREATMENT

If you are installing Stone Parquet in an area where it will be exposed to water, we recommend you lay the tiles as close together as possible and to pretreat the rear of each tile with Fila PW10.

Because of their higher absorbency, Crema d'Orcia and Imperiale should always be protected with a pretreatment before grouting to prevent staining.

BIANCO CARRARA	PIETRA D'AVOLA	CREMA D'ORCIA	IMPERIALE
Strongly recommended: FILA PW10 (water based) One 1-litre bottle every 10/15 sqm. Always follow the instructions on the package.	-	Strongly recommended: FILA PW10 (water based) One 1-litre bottle every 10/15 sqm. Always follow the instructions on the package.	Strongly recommended: FILA PW10 (water based) One 1-litre bottle every 10/15 sqm. Always follow the instructions on the package.

DRYING



Let dry 24 hours before use.

GLUING



Using a toothed spatula, spread a thin layer of adhesive on the laying surface.



Using a smooth trowel, spread a layer of adhesive on the entire rough face (back) of the tile.



Glue the tile to the surface.

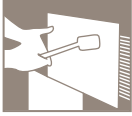

Level the tiles with your hands or with a rubber mallet.

ADHESIVE CLEANING

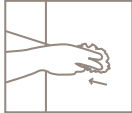

Immediately remove any spills of excess adhesive from the spacing with a damp sponge and clean the adhesive left in the spacing as this could prevent the grout penetrating between the tiles.

RECOMMENDED ADHESIVES

	BIANCO CARRARA	PIETRA D'AVOLA	CREMA D'ORCIA	IMPERIALE
Installation on wood	Mapei Keralastic T white	Mapei Keralastic T grey	Mapei Keralastic T white	Mapei Keralastic T grey
Installation on plasterboard	Mapei Elastorapid white	Mapei Elastorapid grey	Mapei Elastorapid white	Mapei Elastorapid grey
Installation on concrete	Mapei Elastorapid white	Mapei Elastorapid grey	Mapei Elastorapid white	Mapei Elastorapid grey

SPACING AND GROUTING

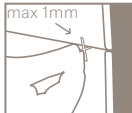

Should you choose to leave a gap between tiles (for example to facilitate the laying of surfaces that are not perfectly flush), we recommend no more than 1mm. Fill the spacing with the recommended grout.



Proceed to fill the spacing with the recommended grout.

CLEANING OF GROUT MATERIAL

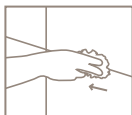

Remove the grout from the tile surface as soon as it starts to dry (within 5-30 minutes of laying).

RECOMMENDED GROUT (in the event of laying with small spacing)

	BIANCO CARRARA	PIETRA D'AVOLA	CREMA D'ORCIA	IMPERIALE
	Mapei Keracolor FF White 100	Mapei Keracolor FF Anthracite 114	Mapei Keracolor FF Jasmine 130	Mapei Keracolor FF Anthracite 114

CLEANING



We recommend the product shown in the table below.

Follow the instructions on the packaging, ensuring you dilute the product as outlined by the manufacturer. Leave it to penetrate for a few minutes, as per the instructions on the packaging, and then clean vigorously, using a single-disc floor machine (where appropriate) or mop or cloth. Remove with a cloth or wet vac. Rinse the surface well.

BIANCO CARRARA	PIETRA D'AVOLA	CREMA D'ORCIA	IMPERIALE
FILA PS87 One 1-litre bottle every 30 sqm.	FILA PS87 One 1 litre-bottle per 30 sqm.	FILA PS87 One 1-litre bottle every 30 sqm.	FILA PS87 One 1-litre bottle every 30 sqm.

DRYING



Let dry 24-48 hours (may require longer, depending on the actual environment's conditions).

FINAL TREATMENT

Once laying is complete, apply a water-oil-repellent product that will protect both the stone and the spacing. Follow the instructions on the package. To prevent possible leakages from staining the material, we suggest always applying the product from the bottom upwards.

NOTE

For surfaces in wet environments, after cleaning apply a coat of FILA HYDROREP, and after 24 hours proceed with the final treatment indicated above. FILA HYDROREP must not be applied to Pietra d'Avola as STONEPLUS (see the table below) already acts as a water-oil-repellent.



BIANCO CARRARA	PIETRA D'AVOLA*	CREMA D'ORCIA	IMPERIALE*
FILAFOB (solvent-based neutral protectant) One 1-litre bottle per 15 sqm for each coat. We recommend the application of two or more coats. Always follow the instructions on the package.	STONEPLUS (solvent-based colour-enhancing protectant) One 1-litre bottle per 20 sqm for each coat. We recommend the application of one coat. Always follow the instructions on the package.	FILAFOB (solvent-based neutral protectant) One 1-litre bottle per 15 sqm for each coat. We recommend the application of two or more coats. Always follow the instructions on the package.	STONEPLUS (solvent-based colour-enhancing protectant) One 1-litre bottle per 20 sqm for each coat. We recommend the application of one coat. Always follow the instructions on the package.

*NOTE

In the case of Pietra d'Avola and Imperiale, to avoid the creation of a "film" on the surface of the stone, any excess of STONEPLUS must be removed within 5-10 minutes with a light-coloured cloth or paper towel. Pass the cloth in the direction of the texture making sure that all excess is removed from the grooves.



Let dry 24-48 hours before use.



After treatment, cover the area with a non-woven fabric so that the surface stays protected during the remaining installation phases. For flooring in particular, it is critical that you use several layers of fabric, so any breakages due to the continuous passage of workers do not uncover the stone and expose it to the possibility of staining or damage.

ONGOING MAINTENANCE AND CLEANING



For routine maintenance of the surfaces, always use neutral cleansers (for example, FILACLEANER or neutral soap). Do not in any case use harsh products that could irreparably damage the surface of the stone (such as acids or descaling products).

We strongly recommend that you do not place hot objects such as kettles or pans directly onto natural stone as it may cause discolouration or staining.

If your stone is exposed to "hard water" where there is a high mineral content, you will need to take a little extra care as the cleaning properties of the FILACLEANER or neutral detergent will be weakened. You will therefore need to use these products a little more frequently so that soap scum, lime scale and the like do not have the chance to build up and congeal.

GLOSSARY OF PRODUCTS

PRETREATMENT

FILA PW10: water-based efflorescence-blocking product which should be applied to the rear of tiles

ADHESIVE

MAPEI KERALASTIC T for installation on wood

MAPEI ELASTORAPID for installation on plasterboard and concrete

GROUT

MAPEI KERACOLOR FF

POST-LAYING CLEANING

FILA PS87: suitable for most types of stone, it is recommended for use during installation and for when particular maintenance is required

FINAL TREATMENT

FILA HYDROREP: to be used for surfaces in wet environments (must not be used with STONEPLUS)

FILAFOB: neutral solvent-based protectant

FILA STONEPLUS: A solvent-based protectant which also enhances the colour of the stone and is recommended for Pietra d'Avola and Imperiale

ONGOING CLEANING

FILACLEANER or neutral soap: a neutral cleaner for normal maintenance of stone surfaces